

CENTURY 29

NEXT DAY SHIP MODEL

CENTURY SERIES MODEL # AI6060-RC29



Two Person Bath



SCALE:
3/8" = 1'

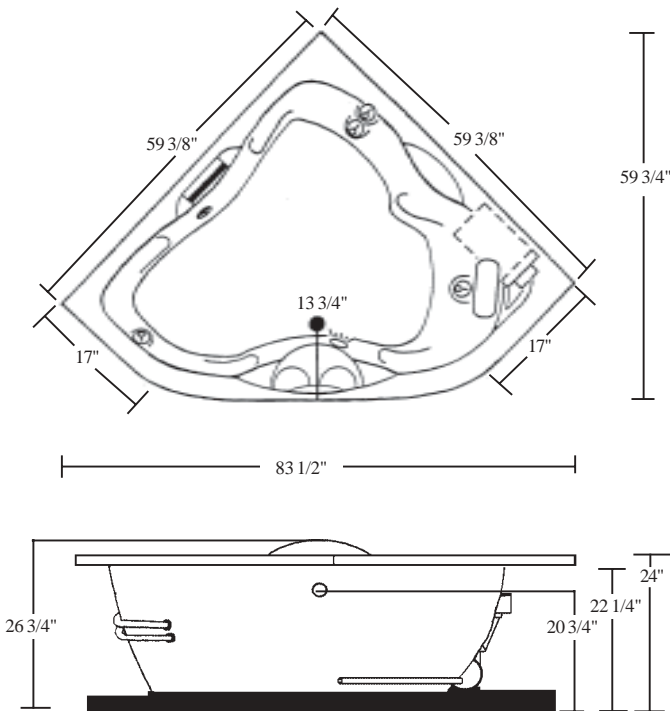

Rough-In Plumbing Measurements

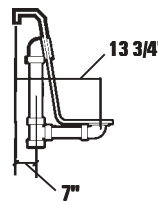

EQUIPMENT LEGEND

- Drain
- Standard Pump Location
- Fan Jet
- Rotary Massage Jet
- Full Size Pressure-Flo Hydrotherapy Jet
- Underwater Mood Light

SPECIFICATIONS:

General Specifications:

Tub Size	59 3/8" x 59 3/8" x 26 3/4"
	151 cm x 151 cm x 68 cm
Bathing Well	Lounge 1: 48" long
	Lounge 1: 21" wide
	Lounge 2: 40 1/2" long
	Lounge 2: 21 1/4" wide
	24" interior depth
Shipping Weight	241 lbs. / 109 kg
Tub Weight Filled	926 lbs. / 420 kg
Gallons to Overflow	115 gal. / 435 L
Gallons to Operate	1 bather: 96 gal. / 363 L
	2 bathers: 77 gal. / 291 L

Electrical Specifications:

Pump	2 HP; 11 AMP; 110V
Requirement	15 AMP; 110V w/ GFCI
Inline Heater	1.5kw; 12 AMP; 110V
Requirement	15 AMP; 110V w/ GFCI

NOTE: Specifications are ± 1/4" and are subject to change without notice.

STANDARD EQUIPMENT:

- 6 Hydrotherapy Jets including:
 - 4 Recessed Rotary Massage Jets
 - 1 Full Size Pressure-Flo Hydrotherapy Jet
 - 1 Recessed Fan Jet
- 2 HP, 3 Speed Run-Dry Pump
- Bath-Side Electronic Control Panel
- Integrally Molded Fast-Fill Waterfall Spout
- Underwater Mood Light with Colored Lens Kit
- Inline Maintenance Heater
- "Quiet Pad" Anti-Vibration Pump Mount for Quiet Pump Operation
- 2 Extra Deep & Wide Contoured Lounge Seats
- Acrylic Grab Bar
- 5 Arm Rests
- Pre-leveled ABS Support Base
- Heat-bent Rigid PVC Piping for Optimum Sanitary Conditions
- Durable, Easy to Clean, Lucite® Cast Acrylic Surface Available in 8 Standard No-Charge Colors
- UL & IAPMO Listed, Factory Tested
- Limited 15 Year Warranty

OPTIONAL EQUIPMENT:

- Available without Fast-Fill Waterfall Spout*
- See Price List for Details
- Comfort Pillow - Oval or Rectangle
- Jet Finish
- Chrome, Polished Brass, Gold, Polished Nickel or Satin Nickel
- Lift & Turn Waste and Overflow
- Chrome, Polished Brass, Gold, Polished Nickel or Satin Nickel
- Cable Drive Waste and Overflow
- Chrome, Polished Brass, Gold, Polished Nickel, Satin Nickel or Color Matched (Bone, White & Biscuit Only)
- Hand Held Jet
- Tile Flange Kit
- Factory Installed Rigid ABS Tile Flange
- Decorative Rim Kit - Chrome or Polished Brass
- Remote Pump Location
- Color Matched Curved Acrylic Skirt
- Custom or Premium Colors

All acrylic colors featured by Aquatic match the industry's leading fixture manufacturers.

**Electronic Control Panels are not installed on units with Fast-Fill Waterfall Spouts removed.*

Fax-On-Demand Document # 1013



The Century 29 offers a beautiful corner unit with an extra deep bathing well. It includes all the Century Series standard features, such as: bath-side electronic control with digital display for operation of the inline heater and the 2 HP, 3-speed run-dry pump, an underwater mood light and an integral waterfall fill spout. The Century 29 features six full size hydrotherapy jets, including three recessed **Rotary Massage Jets**, two **Full Size**

Pressure-Flo Hydrotherapy Jets and one **Fan Jet**. Two **Rotary Massage Jets** are stacked in one station. These jets generate a powerful rotating massage action that is directionally and pressure adjustable for custom flexibility. At the second station the **Fan Jet**, positioned above a **Rotary Massage Jet**, provides a pulsating hydro-massage with oscillating streams of air and water pushing and pulling across tired, aching muscles.