

# NEO-METRO<sup>®</sup> Collection

## NEO-Tub



### Features

- Large One-Piece Soaking Tub
- Heavy Gage Stainless Steel Construction
- Available in capacities of 90-Gallons /341 Liters (8970) or 105-Gallons /398 Liters (8971)
- Reinforced Tank Rim
- Extended Skirt Conceals Internal Drain Piping
- 2" (51 mm) Diameter Combination Drain and Overflow
- Custom Sizes and Features can be Fabricated to Your Specs  
- Please Contact Neo-Metro with Custom Specs and Drawing for Quotation
- Optional - Reclining Seat is available



Model 8971  
105-Gallon (397 Liter)  
Capacity  
Shown: -AL Angled Left

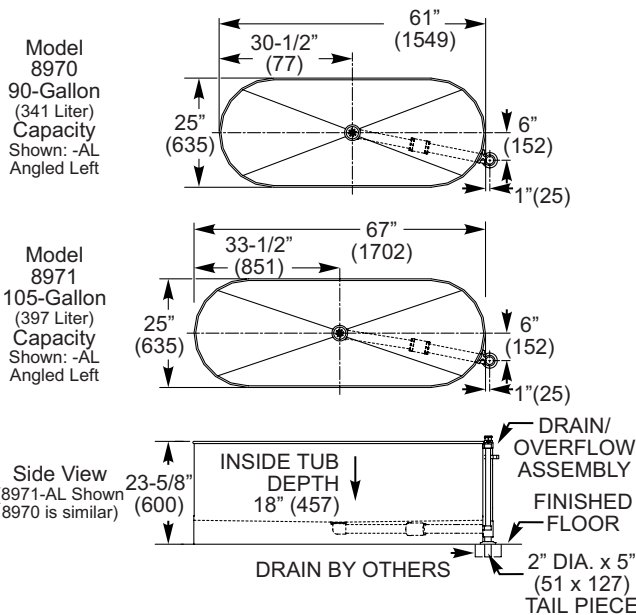

### Ordering Options

- 8970 Neo-Tub - 90 Gallon (341 Liter) 60" Long (1524mm) Satin Finish**
- 8971 Neo-Tub - 105 Gallon (398 Liter) 66" Long (1676mm) Satin Finish**

Either 8970 or 8971 Tubs Must Specify  
Drain/Overflow Assembly Configuration:

- (-AL) Angled Left
- (-AR) Angled Right

**- RS Option - Reclining Seat**

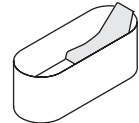

**Product Specification . . .** Tub shall be manufactured with heavy gage, Type 304 stainless steel. Construction shall be seamless welded and exposed surfaces shall be polished to a satin finish. Tub shall have a reinforced rim and be fitted with a skirt flush to the floor line. A 2" (51 mm) combination drain and overflow assembly is provided.

**Plumbing Specification . . .** Drain in the tub floor is positioned in the center. Water drains out to the 2" (51 mm) combination drain and overflow assembly positioned toward the end of the tub in Angled Right (-AR) or Angled Left (-AL) configuration. Faucet not provided.

Approved for Manufacturing

All dimensions are nominal and subject to manufacturer's change without notice.

Company	Project Name	Authorized Signature	Name Written Clearly	Date
---------	--------------	----------------------	----------------------	------

Neo-Metro Collection is a division of Acorn Engineering Company.

**Call Us at (800) 591-9050 • Web Site: [www.neo-metro.com](http://www.neo-metro.com)**

NEO-METRO Collection • P.O. Box 3527 • City of Industry, CA 91744 USA • Phone (626) 855-4854 • Fax (626) 937-4725