

SPECIFICATION SUBMITTAL SHEET



TP1100A



P1000A

FEATURES

(T&P valve)

Probe sizes: 2" 3" 4" 5" 8"

OPTIONS

- E - Model TP1100AE extended body
- F - Model P220 or TP220 with FNPT inlet

ACCESSORIES

- Expansion tank (Model WXTP)
- Water pressure reducing valve (Model BR4)
- Vacuum Relief Valve (Model VR10)
- Dielectric Nipples (Model DN)
- Expansion control ball valve (Model BVEC)

APPLICATION

Designed for installation on potable water heating storage vessels to protect against over-temperature or excessive pressure.

STANDARDS COMPLIANCE

- CSA Compliance to ANSI Z21.22/CSA 4.4
- Certified to ASME Section IV by National Board
(see below for applicable models and pressure settings)

MATERIALS

Main valve body Cast Brass or Bronze, ASTM B 584
Internals Stainless Steel, 300 Series
Brass, ASTM B 36 and B 16
Buna Nitrile, Silicone
Springs Stainless Steel, ASTM A 313
Music Wire, ASTM A 228
Probes Epoxy Coated copper tube, FDA approved

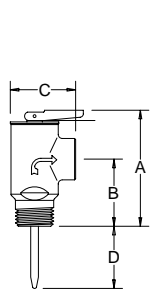

TP1100A

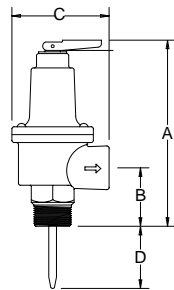

TP220

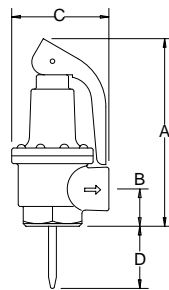

TP3000

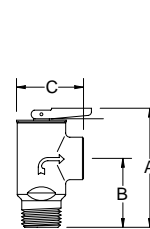

P1000A

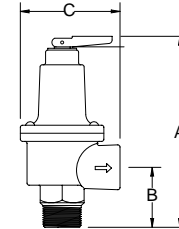

P220

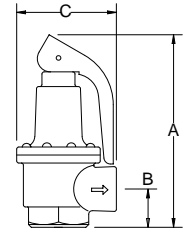

P3000

DIMENSIONS & WEIGHTS (do not include pkg.)

MODEL NUMBER	DISCHARGE RATINGS				RELIEF TEMP	DIMENSIONS (approximate)										weight	
	ANSI Z21.22/CSA 4.4		ASME (SECTION IV)			INLET	OUTLET	A		B		C		D			
	PRESSURE RELIEF SETTING (psi)	BTU/HR	SETTING (psi)	BTU/HR				in.	mm	in.	mm	in.	mm	in.	mm		
														lbs.	kg		
TP1100A-2C	75-175	80,000	150	700,000	210°F	3/4" MNPT	3/4" FNPT	3 5/16	84	1 3/4	45	1 7/8	48	1 7/8	48	0.6	0.3
TP1100AE-3C	75-175	100,000	150	700,000	210°F	3/4" MNPT	3/4" FNPT	4 5/16	110	2 3/4	70	1 7/8	48	2 1/2	64	0.6	0.3
TP1100A-4C/8C	75-175	100,000	150	700,000	210°F	3/4" MNPT	3/4" FNPT	3 5/16	84	1 3/4	45	1 7/8	48	3 1/2 / 7 5/8	89 / 194	0.6	0.3
TP220-3C	75-150	180,000	125/150	1,500,000	210°F	3/4" MNPT*	3/4" FNPT	5 9/16	141	1 1/8	29	2 3/4	70	2 7/8	73	1.7	0.75
TP220-5C/8C	75-150	200,000	125/150	1,500,000	210°F	3/4" MNPT*	3/4" FNPT	5 9/16	141	1 1/8	29	2 3/4	70	4 7/8 / 7	124 / 178	1.7	0.75
TP3000-5C/8C	75-175	715,000	125/150	2,750,000	210°F	1" FNPT	1" FNPT	7 1/16	179	1 1/2	38	3 9/16	91	5 5/16 / 7 3/8	135 / 187	3	1.4
P1000A	15-175	200,000	30	250,000	N/A	3/4" MNPT	3/4" FNPT	3 5/16	84	1 3/4	45	1 7/8	48	N/A	N/A	0.5	0.25
P220	30-150	200,000	N/A	N/A	N/A	3/4" MNPT*	3/4" FNPT	5 9/16	141	1 1/8	29	2 3/4	70	N/A	N/A	1.5	0.7
P3000	30-150	200,000	N/A	N/A	N/A	1" FNPT	1" FNPT	7 1/16	179	1 1/2	38	3 9/16	91	N/A	N/A	4	1.8

TYPICAL INSTALLATION

Local codes shall govern installation requirements. Unless otherwise specified, the relief valve shall be installed in accordance with manufacturer's instructions and the latest edition of the Uniform Plumbing Code ®.

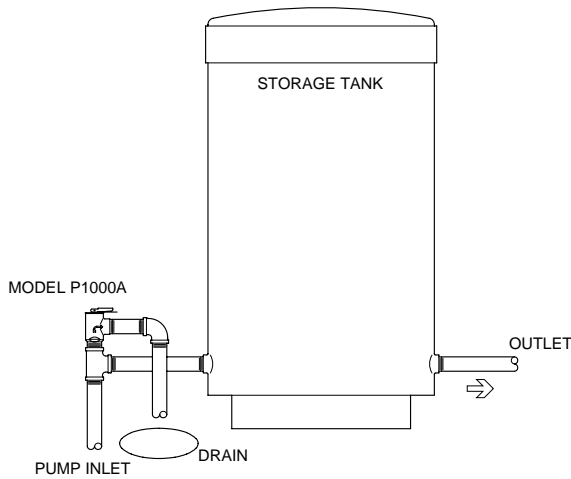

TYPICAL INSTALLATION

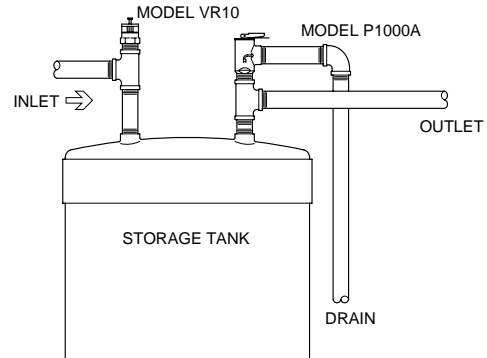

TYPICAL INSTALLATION

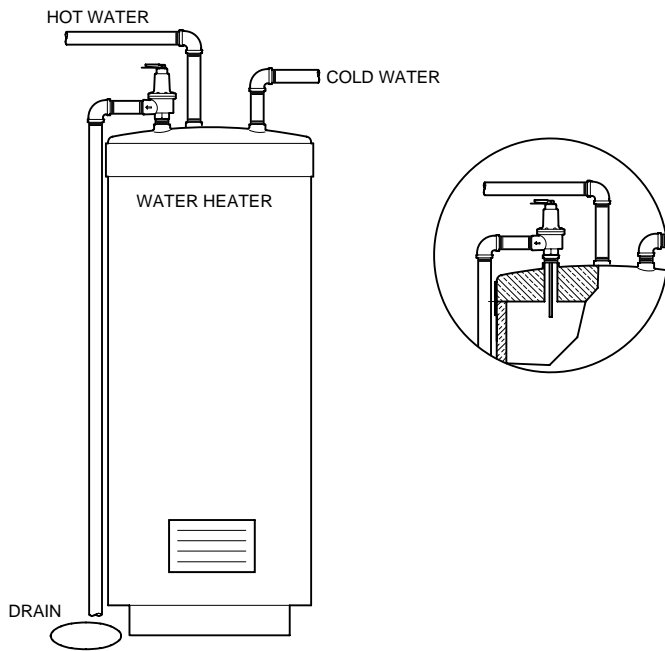

TYPICAL INSTALLATION

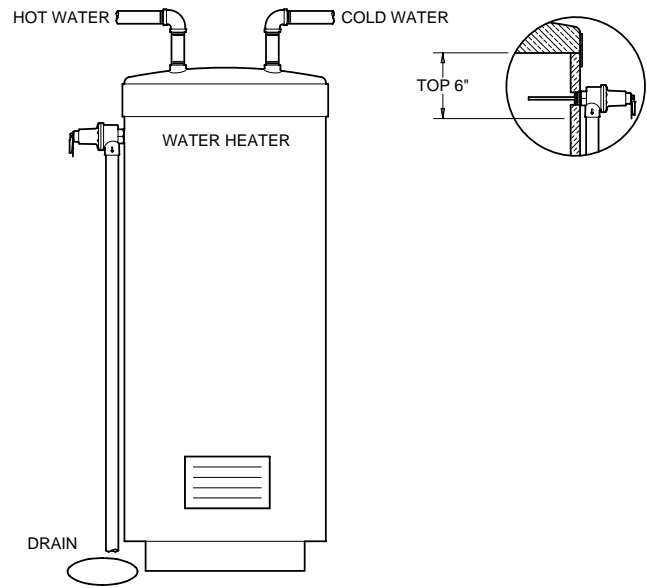

TYPICAL INSTALLATION

SPECIFICATIONS

The Relief Valve shall meet the requirements of the ASME Boiler and Pressure Vessel Code (Section IV) and shall be CSA Design Certified (ANSI Z21.22/CSA 4.4). Where pressure only relief is required, the assembly shall be a WILKINS Model P1000A, P220 or P3000. Where temperature and pressure relief is required, the assembly shall be a WILKINS Model TP1100A, TP220 or TP3000.